

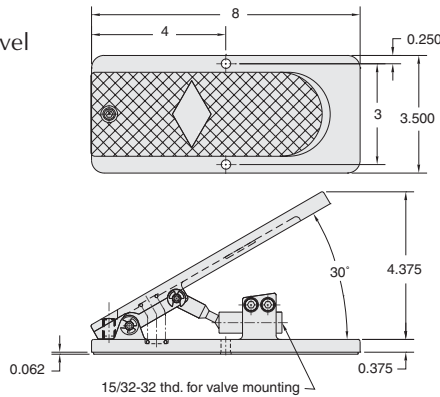

# VALVE ACTUATORS

## Foot Pedal

Adjustable travel foot pedal



Part No.	Description
<b>FPA-1</b>	<b>Adjustable Travel Foot Pedal</b>

**Construction:** Sturdy cast aluminum and black oxidized steel

**Control Devices:** May be fitted with any Clippard 2-, 3- or 4-way valve or MAR-1C pressure controller with a #15/32-32 mounting thread

**Mounting:** To floor or other structure with two 9/32" mounting holes stroke plunger adjustable to accommodate a variety of valves

"Hands-free" touch-of-toe operation of endless types of automated and semi-automated machinery and equipment, jigs and fixtures, is possible thru use of this sturdy treadle type foot pedal, combined with Clippard miniature valves, plunger type air pressure controls, and electrical switch.

A sliding link mechanism between treadle and mounting sleeve actuates the component, and a set screw at the back of pedal base adjusts treadle travel.

Pedal is spring loaded at approximately 1/2 lb. for return to "off" position.

### Note for MBA-1, 11925 & 12296:

When mounting on a valve, a space should be provided between the body and the actuator according to the chart to the right:

Valve Mtg. Thd.	MBA-1	11925	12296
0.250 thd. length	0.125"	0.062"	0.062"
0.373 thd. length	0.218"	0.188"	0.188"

A mounting nut (supplied with valve), mounting bracket or washers should be used to obtain the required spacing.

## Ball Cam Actuator



Ball Cam Actuator permits the valves and electrical switch to be operated by mechanical movement depressing the ball from any direction

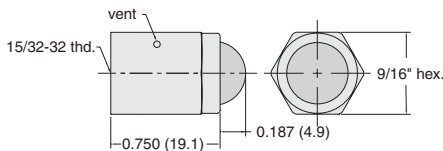

**Construction:** Body - brass  
Ball - stainless steel retained in housing

**Operation:** Will actuate valve while depressed from any (360°) direction

**Mounting:** #15/32-32 female to mount to Clippard miniature valves and electric switch

Part No.	Description
<b>MBA-1</b>	<b>Ball Cam Actuator</b>

## Roller Cam Actuator

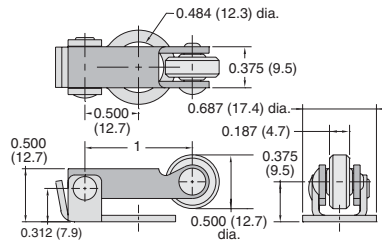

**Construction:** Stainless steel with nylon roller

**Temperature Range:** 32 to 230°F

**Mounting:** 31/64" dia. mounting hole fits #15/32-32 threaded mounting section of valve bodies

**Operation:** Mounts to valve body, actuates valve when mechanically depressed; valve spring provides return

Part No.	Description
<b>11925</b>	<b>Roller Cam Follower Actuator</b>

## Double-Pivoted Actuator

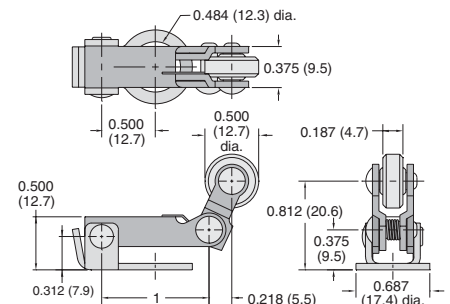

**Construction:** Stainless steel with nylon roller

**Mounting:** 31/64" dia. mounting hole fits #15/32-32 threaded mounting section of valve bodies

**Operation:** Mounts to valve body, actuates valve when depressed by activating cam or linear travel device in one direction only; no actuation on return travel

Part No.	Description
<b>12296</b>	<b>Roller, Double-Pivoted One-Way Cam Follower Actuator</b>